

1		
Description	Material	Finish
Body	Brass	Gold
Pin	Brass	Gold
Insulation	Teflon	Teflon
Snaps	BE CU	Gold
Spacer	Teflon	Teflon
Support	Brass	Gold

SIDE VIEW

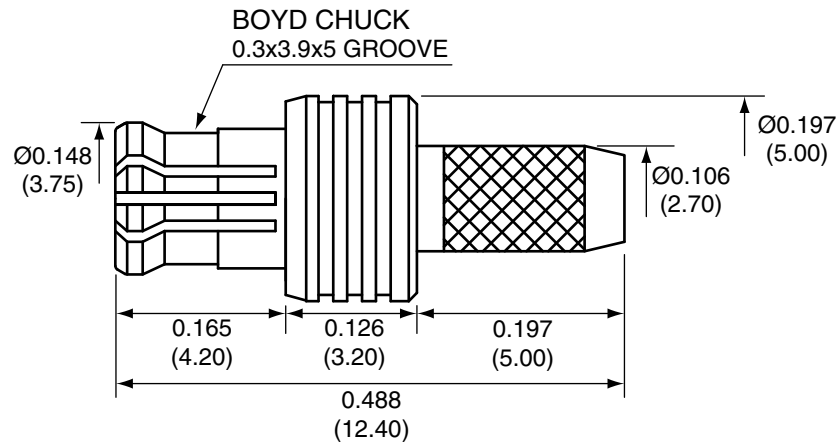

PIN

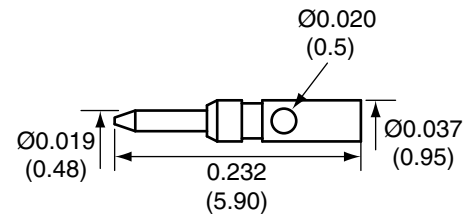

SPACER



SUPPORT

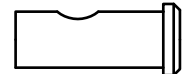

RECOMMENDED CABLE STRIPPING DIMENSIONS

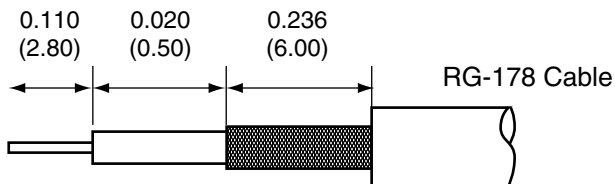

CONMCX007-R178 ASSEMBLY INSTRUCTIONS

1. Strip the cable to the recommended dimensions.
2. Solder the support onto the braid.
3. Place the spacer onto the center conductor.
4. Solder or crimp the pin onto the center conductor.
5. Insert the pin, center conductor, spacer, and support into the body until the pin snaps in.
6. Crimp the tail of the body onto the support with a hex crimp tool.

Title		CONMCX007-R178 ASSEMBLY INSTRUCTIONS	
MCX MALE CABLE END CRIMP FOR RG178 CABLE		CONNECTOR CITY 159 ORT LANE MERLIN, OR 97532 PH (541)-471-6256 FAX (541)-471-6251	
Part No.	CONMCX007-R178	Revision:	1.0
Dimensions:	INCHES (mm)	Date:	6/8/2006
		Sheet 1 of 1	

**CONNECTOR CITY**  
THE VALUE OF CONNECTIONS